

Thermo Sensor Setup – UTY-RVNUM

1. From the monitor screen, press the MENU button twice to get into the submenu screen.
2. Once in the submenu press and hold the LEFT and RIGHT switch screen buttons for 5 seconds.
3. Select Function Setting from the menu and press ENTER.
4. The function setting for turning on the room sensor is '42:01'. If you like to sense only at the wired remote, set '48' to '01' too. Be sure to press ENTER to lock in the function setting. If you have a wall mount, cassette, or universal evaporator, the indoor unit will beep.
5. Press CANCEL to exit the screen. IMPORTANT, shut off power at the outdoor disconnect for a minimum of 1 minute.
6. Upon turning power back on, go back to the submenu, menu twice at the monitor screen and the R.C. sensor control will be shown. Highlight and turn on. Go back to the monitor screen and the thermo sensor icon will be lit up.

*See attached, 'How to Enter Function Settings' Engineering Bulletin'.

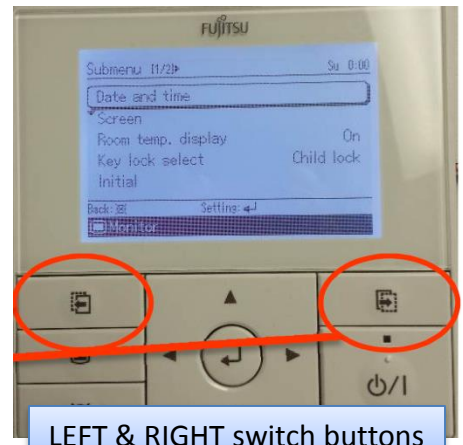

LEFT & RIGHT switch buttons

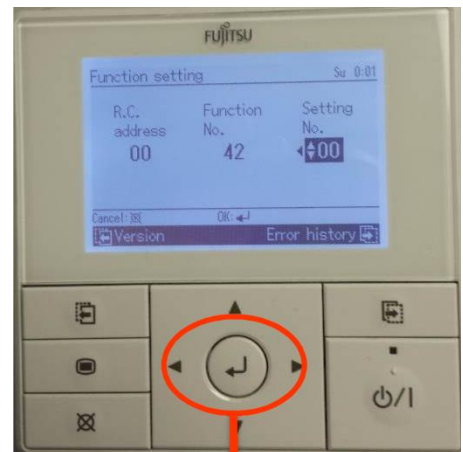

Press ENTER to lock in.

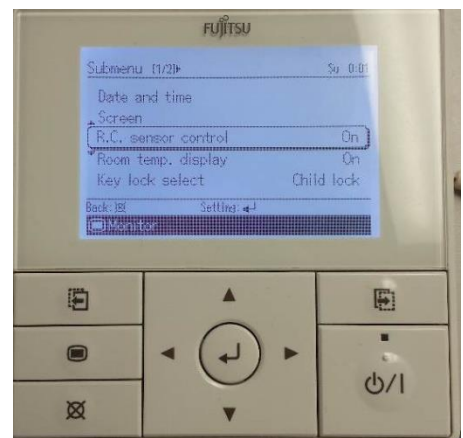

Entering Function Settings

UTY-LNHUM / UTY-LRHUM

Entering the Function Setting Mode:

Press the Fan (Control) button, Set Temp.(**^**) and the Reset button simultaneously then release the Reset button to enter the function setting mode.

Selecting the Function Number and Setting Value

1. Press the Mode button first then press the Set Temp. (**^**)(**v**) buttons to select the function number. (Press the Mode button to switch between the left and right digits.)
2. Press the Fan button to proceed to setting the value. (Press the Fan button again to return to the function number selection.)
3. Press the Set Temp. (**^**)(**v**) buttons to select the setting. (Press the Mode button to switch between the left and right digits.)
4. Press the Timer Mode button and Start/Stop button, in the order listed to confirm the settings.
5. Press the Reset button to cancel the function setting mode.
6. After completing the Function Setting, be sure to turn off power to the outdoor disconnect for a minimum of one minute and turn it on again.



AR-REC1U / AR-RED1U / AR-REG1U

Entering the Function Setting Mode:

Press the Powerful button, Set Temp.(**^**) and Reset button simultaneously then release the Reset button to enter the function setting mode.

Selecting the Function Number and Setting Value

1. Press the Set Temp. (**^**)(**v**) buttons to select the function number. (Press the Min. Heat button to switch between the left and right digits.)
2. Press the Powerful button to proceed to setting the value. (Press the Powerful button again to return to the function number selection.)
3. Press the Set Temp. (**^**)(**v**) buttons to select the setting. (Press the Min. Heat button to switch between the left and right digits.)
4. Press the Mode button and then the Start/Stop button, in the order listed to confirm the settings.
5. Press the Reset button to cancel the function setting mode.
6. After completing the Function Setting, be sure to turn off power to the outdoor disconnect for a minimum of one minute and turn it on again.



UTY-RVNUM

Entering the Function Setting Mode:

1. Make sure the indoor unit is powered down and not running otherwise you will be restricted from entering the Function Settings menu.
2. From the monitor screen, press the Menu button twice.
3. Once at the submenu, press and hold the Screen Left and Screen Right buttons for 5 seconds.
4. Select the Function Setting option from the list. From there you will be in the Function Settings Menu and free to select function number and setting values.
5. After completing the Function Setting, be sure to turn off power to the outdoor disconnect for a minimum of one minute and turn it on again.



UTY-RNBYU / UTY-RNNUM

Entering the Function Setting Mode:

1. Press the Set Temp. (**^**)(**v**) buttons and Fan button simultaneously for more than 5 seconds to enter the function setting mode.
2. Press the Set Back button to select the indoor unit number.
3. Press the Set Time buttons to select the function number.
4. Press the Set Temp. buttons (**^**)(**v**) to select the setting value. The display flashes as shown to the right during setting value selection.
5. Press the Timer Set button to confirm the setting. Press the Set button for a few seconds until the setting value stops flashing. If the setting value display changes or if “- -” is displayed when the flashing stops, the setting value has not been set correctly. (An invalid setting value may have been selected for the indoor unit.)
6. Repeat steps 2 to 5 to perform additional settings. Press the Set Temp. buttons (**^**)(**v**) and Fan button simultaneously again for more than 5 seconds to cancel the function setting mode. In addition, the function setting mode will be automatically canceled after 1 minute if no operation is performed.
7. After completing the Function Setting, be sure to turn off power to the outdoor disconnect for a minimum of one minute and turn it on again.



UTY-RSNUM

Entering the Function Setting Mode:

1. Press both the Temp. Up and Down buttons (**^**)(**v**) and FAN together for more than 5 seconds simultaneously. Then, shift to Function Setting Mode.
2. Press the Temp. Up or Temp. Down button (**^**)(**v**) and select the indoor unit number. Then, press the Fan button.

Function Number & Setting Number Setting

3. “Function Number” display blinks. Then, display Number by pressing the Temp. Up or Temp. Down button.
4. When the “Setting Number” blinks, press the Fan button to set the Setting number by pressing the Temp. Up or Temp. Down button (**^**)(**v**).
5. Fix the setting by pressing the power button. (Data is transferred to the indoor unit).
6. After completing the Function Setting, be sure to turn off power to the outdoor disconnect for a minimum of one minute and turn it on again.

