

WARNING

INSTALLATION INSTRUCTIONS

Included in this KIT C:

K0700095054 Screw M4 L16 – 4pcs.

K0000036795 Heat Sink Grease 1pc.

K9705840010 Pink Insulation Sheet 1pc.

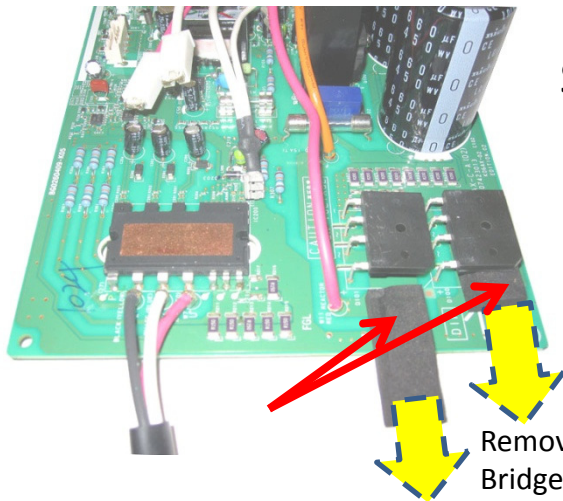

Step 1

Remove Cushions off Diode Bridges Before Installing PCB

Apply Heat Sink Grease to the IPM IC

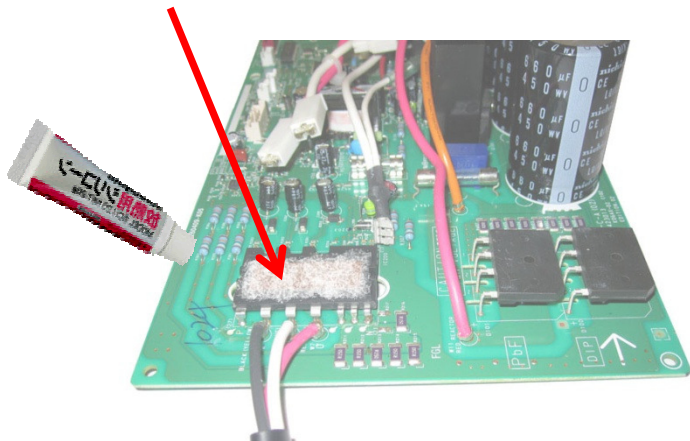

Step 2

Step 3

Apply Heat Sink Grease to the Heat Sink side

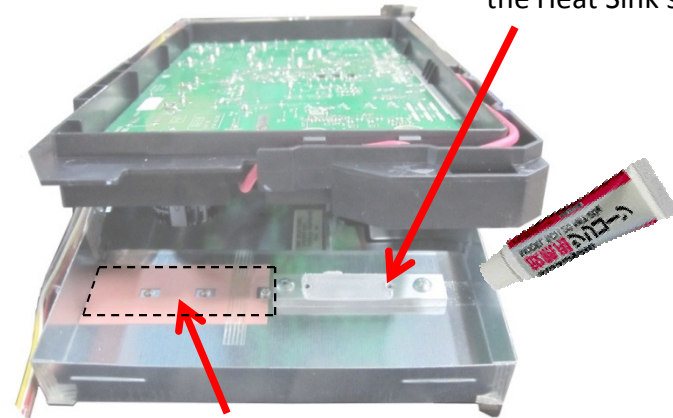

Place insulation sheet on the heat sink , Diode Bridge Side (Pink)

Step 4

Secured PCB with enclosed screws

